

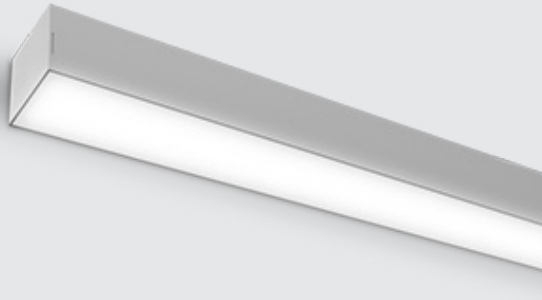

Date: _____ Fixture: _____
 QTY: _____ Project: _____



Thinline

Wall Mount Direct-Indirect

Cast End Caps with Light Block
 Multiple Lens and Customizations Available

Architectural luminaire. Contemporary and minimal design. Aluminum extruded body. Wall mount applications. Direct-Indirect distribution. 2.25", 3.18", and 4.5" widths. Continuous runs available. L90>70K hours. cULus Listed.

Designed and manufactured in North America.
 5 Year Warranty.

Model Shown: DTL 4.5

Ordering Options

Model	Width	Continuous Run	Direct Lm/ft	Indirect Lm/ft	CRI	Color Temp	Voltage
DTL WM DI	2.25 3.18 4.5	CR _____ Min 2Ft - Available in 6in increments - Unibody up to 8Ft	D 250 D 500 D 750 D 1000 D _____ <i>(custom up to 1200)</i>	I 250 I 500 I 750 I 1000 I _____ <i>(custom up to 1200)</i>	80 90	27K 2700K 3K 3000K 35K 3500K 4K 4000K 5K 5000K	U 120/277V H 347V

DTL WM DI							
-----------	--	--	--	--	--	--	--

Direct Lens	Indirect Lens	Finish	Mounting	Driver
FR Frosted FRREG Frosted Regressed ASY Asymmetric .5 FR DROP .5" Frosted Drop Lens 1.5 FR DROP 1.5" Frosted Drop Lens LVR Louver Lens	FR Frosted ASY Asymmetric BATWING Batwing	GRY Grey WH White BLK Black CU Custom	WM Wall Mount Bracket 12EX 12" Extended Arm	DIMOFF 0-10 1% DIMOFF LUTRON Lutron Ecosystem SR Philips SR DALI ELDO .1% ELDO (347 only 1-10 5%)

Controls	Circuits	Accessories	Wiring
N None DMX SNS Philips SNS 300 w/BLD & Daylight CLM Encelium CLM LG LG Dongle BT Bluetooth Mesh EN Enlighted Integral	1 1 Circuit 2 2 Circuit	N None 10kV 10kV Surge Protection EMBAT 6W 90 Min Battery	N None <i>(will provide 5 leads from mounting plate)</i>

Sample Configuration: DTL WM DI - 4.5 - 8 - D 250 - 80 - 4K - U - FR - GRY - S - DIMOFF - N - 1 - N - N

LED

L90 > 70,000
 Samsung 301 3 McAdam Binning
 4000K 120 Lm/W
 3500K 98%
 3000K 96%
 90 CRI 85%

Performance

Model	Watts
4000K	120 Lm/W
3500K	116 Lm/W
3000K	112 Lm/W

Optics - Direct Distribution

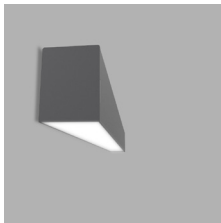

Flat

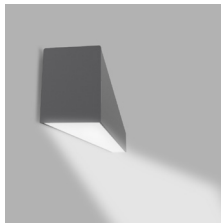

Asymmetric

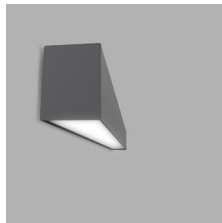

0.25" Regressed

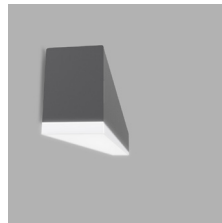

0.5" Drop Lens

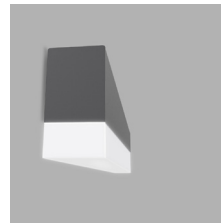

1.5" Drop Lens

Lens Options - Indirect

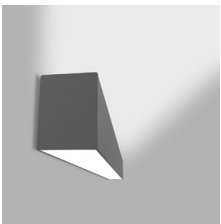

Flat

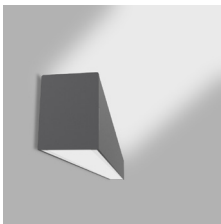

Asymmetric

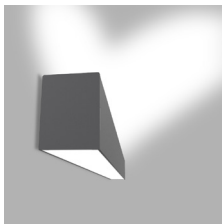

Batwing

Dimensions

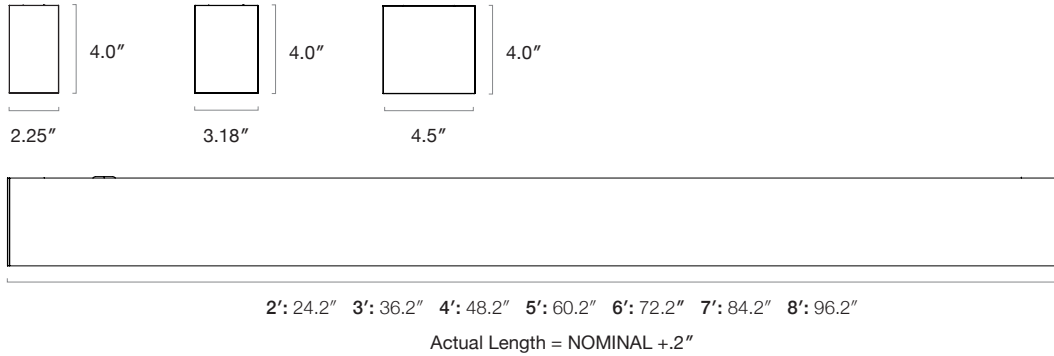

Mounting - Wall Mount Bracket

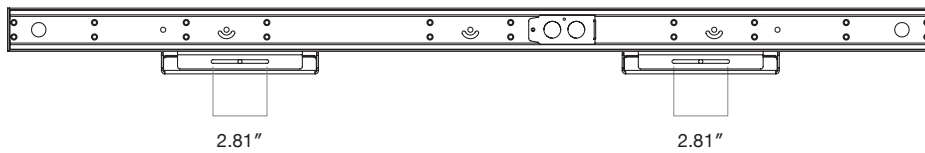

This is the central position of the wall mount bracket.
It can be adjusted Left/Right by 1.4". Secure light fixture using #8-32 screws (2x).

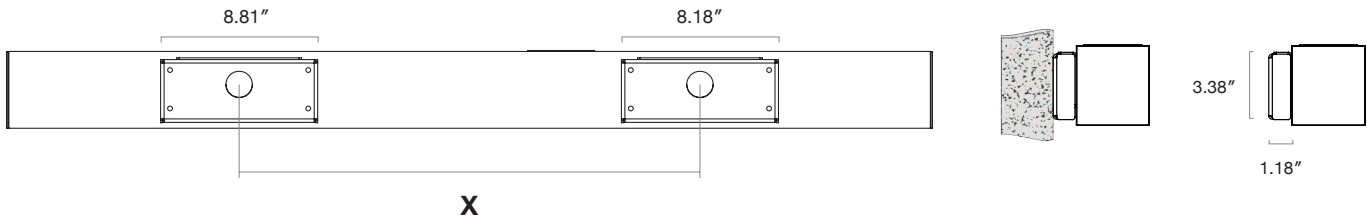

Mounting Locations

Thinline Model	Mounting Reference
DTL 2	Centerline
DTL 3	
DTL 4	8" From Fixture Ends
DTL 5	
DTL 6	
DTL 7	Centerline & 8" From Fixture Ends
DTL 8	

12" Extended Arm

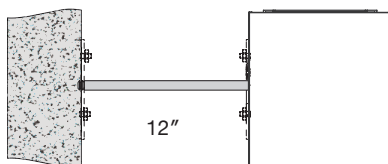

Finish Options

Standard Finishes



Grey
RAL 7046
Sandtex



White
RAL 9003
Sandtex



Black
RAL 9004
Sandtex

Custom Finishes



Orange
RAL 2009
Sandtex



Green
RAL 6010
Sandtex



Blue
RAL 5012
Sandtex



Yellow
RAL 1037
Sandtex

Additional finishes - Please contact factory