

Airflex

Installation Manual: V-Hook with Jack Chain

Safety & Warnings:

Failure to follow these instructions and warnings may result in death, serious injury or significant property damage.

Warning: Risk of Fire and Electrical Shock. Fixture must be installed by a qualified electrician only in accordance with National, Local Building, and Electrical Codes. Disconnect power at the electrical panel before servicing.

 General contractor is responsible for the installation of appropriate anchors to support the load of the fixture at positions detailed in the installation manual. Installation of such anchors or other support systems must be completed in accordance with applicable building/ installation code.

Steps

1.
 - Disconnect the electrical power on the electrical panel prior to installing the Airflex light fixture.
2.
 - The Airflex fixture is shipped with two (2) V-Hooks - one at each end of the fixture.
 - Ensure that the V-Hooks are oriented the same as in Fig. 1.
 - Use pliers to close off the ends of the V-Hooks such that the hooks can't be taken off.
3.
 - Attach an S-Hook to the top of the V-Hook and then attach the other side of the S-Hook to the jack chain (minimum #10 size).
 - Use pliers to close off the ends of the S-Hooks onto the V-Hook and jack chain (minimum S-Hook size: 1.625" long, 0.135" thick with 0.5" ID in steel).
 - At the top of the jack chain attach an S-Hook to the jack chain and the other end of the jack chain to an eye lag screw.
 - The installer should choose the proper eye lag screw as there are different types used for wood, steel, and concrete (minimum eye lag screw should be #12 size).

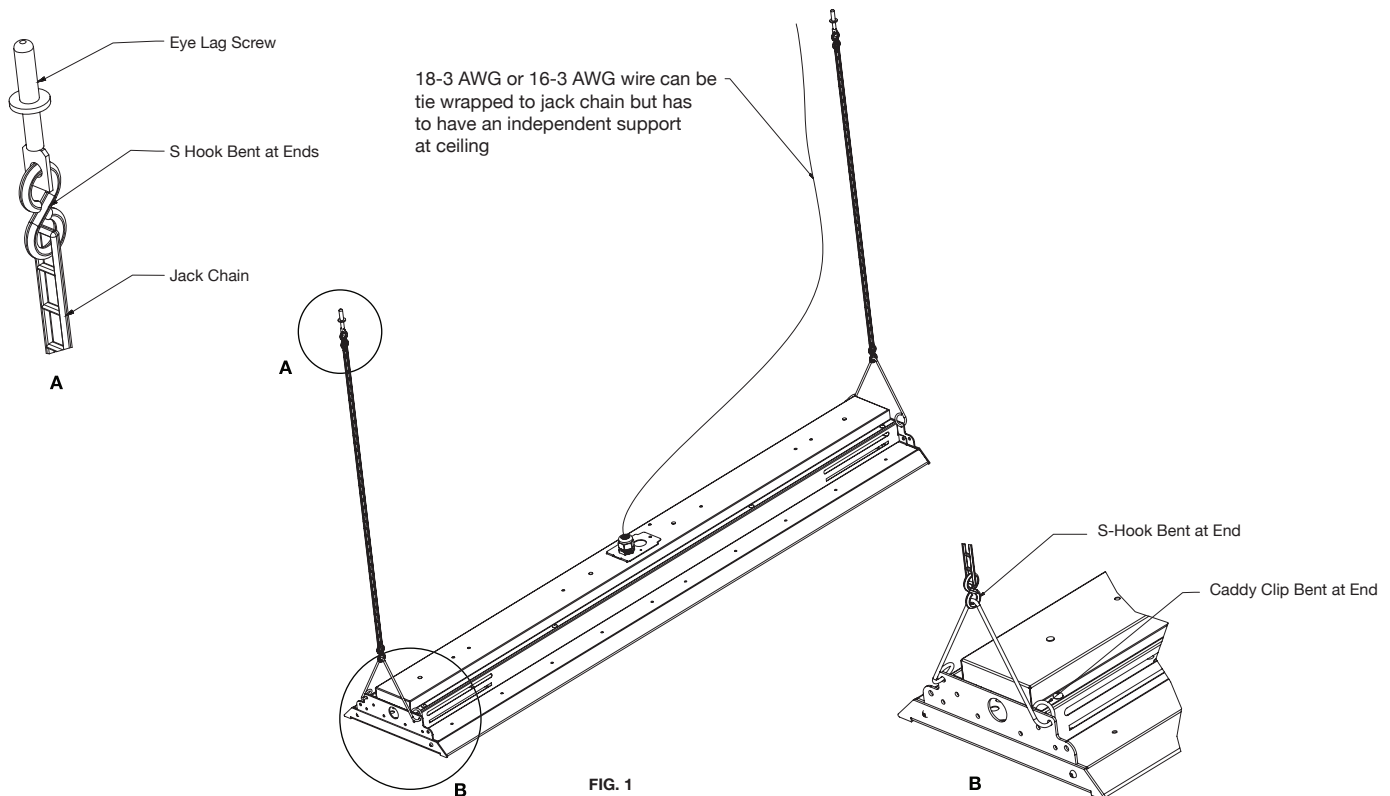

4.
 - Pull the existing 18-3 AWG or 16-3 AWG wire from the Airflex fixture into the junction box.
 - Use a strain relief on the access plate if required.
 - Connect the appropriate wires using wire nuts (black to black, white to white, and green to ground wire).
 - Ensure the ground wire is also grounded to the junction box using a ground screw.
 - The 18-3 AWG or 16-3 AWG wire from the Airflex fixture can be tie wrapped to the aircraft cable but also has to be independently supported to the ceiling or roof.
 - Check to see if the Airflex fixture is securely in place and that the jack chain is properly attached to the ceiling and the fixture.
5.
 - Check all connections for open loops and replace loose/damaged wires.
 - Turn the electrical power on from the electrical panels.
6.
 - Test the connection by turning on the timer, relay system, motion detector or light switch that the Airflex fixture is connected to.